

USER MANUAL

CS600



SCAN for more

User Manual
Manual del usuario
Benutzerhandbuch
Manuale Utente
Manuel d'utilisation
取扱説明書



A L L A B O U T P A S S I O N

Product Accessories

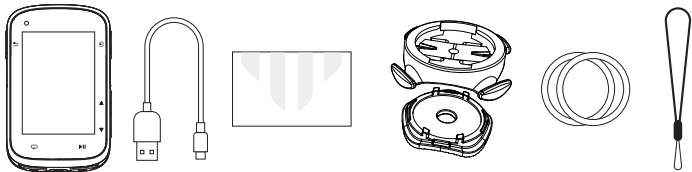

Charging

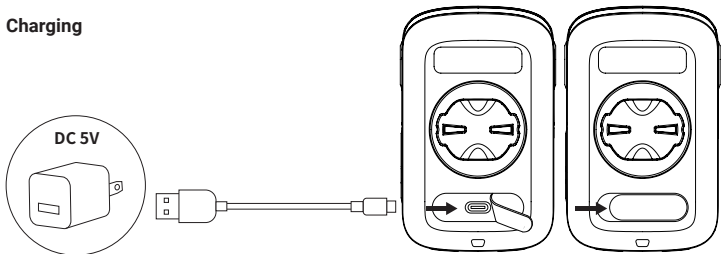

How to Install

1

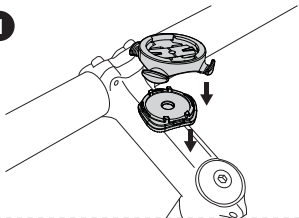

2

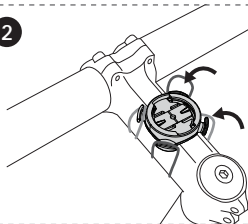

3

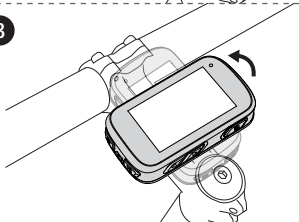

4

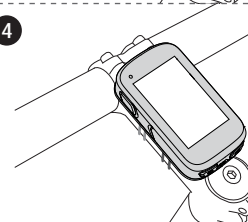

Common wheel size and circumference(Wheel Size L (mm))

<u>12 × 1.75 935mm</u>	<u>24 × 2.00 1925mm</u>	<u>26 × 1.40 2005mm</u>	<u>700 × 18C 2070mm</u>
<u>14 × 1.5 1020mm</u>	<u>24 × 2.125 1965mm</u>	<u>26 × 1.50 2010mm</u>	<u>700 × 19C 2080mm</u>
<u>14 × 1.75 1055mm</u>	<u>26 × 1.75 2023mm</u>	<u>27 × 1 2145mm</u>	<u>700 × 20C 2086mm</u>
<u>16 × 1.5 1185mm</u>	<u>26 × 1.95 2050mm</u>	<u>27 × 1-1/8 2155mm</u>	<u>700 × 23C 2096mm</u>
<u>16 × 1.75 1195mm</u>	<u>26 × 2.00 2055mm</u>	<u>27 × 1-1/4 2161mm</u>	<u>700 × 25C 2105mm</u>
<u>18 × 1.5 1340mm</u>	<u>26 × 2.10 2068mm</u>	<u>27 × 1-3/8 2169mm</u>	<u>700 × 28C 2136mm</u>
<u>18 × 1.75 1350mm</u>	<u>26 × 2.125 2070mm</u>	<u>27.5×1.75 2114mm</u>	<u>700 × 30C 2170mm</u>
<u>20 × 1.75 1515mm</u>	<u>26 × 2.35 2083mm</u>	<u>27.5×2.125 2174mm</u>	<u>700 × 32C 2155mm</u>
<u>20 × 1-3/8 1615mm</u>	<u>26 × 3.00 2170mm</u>	<u>27.5×1.5 2074mm</u>	<u>700C Tubular 2130mm</u>
<u>22 × 1-3/8 1770mm</u>	<u>26 × 7/8 1920mm</u>	<u>27.5×1.95 2146mm</u>	<u>700 × 35C 2168mm</u>
<u>22 × 1-1/2 1785mm</u>	<u>26 × 1(59) 1913mm</u>	<u>29×2.1 2288mm</u>	<u>700 × 38C 2180mm</u>
<u>24 × 1 1753mm</u>	<u>26 × 1(65) 1952mm</u>	<u>29×2.2 2298mm</u>	<u>700 × 40C 2200mm</u>
<u>24×3/4 Tubular 1785mm</u>	<u>26 × 1.25 1953mm</u>	<u>29×2.3 2326mm</u>	<u>700 × 42C 2224mm</u>
<u>24 × 1-1/8 1795mm</u>	<u>26 × 1-1/8 1970mm</u>	<u>650× 35A 2090mm</u>	<u>700 × 44C 2235mm</u>
<u>24 × 1-1/4 1905mm</u>	<u>26 × 1-3/8 2068mm</u>	<u>650 × 38A 2125mm</u>	<u>700 × 45C 2242mm</u>
<u>24 × 1.75 1890mm</u>	<u>26 × 1-1/2 2100mm</u>	<u>650 × 38B 2105mm</u>	<u>700 × 47C 2268mm</u>

Table of Contents

English	1
Español	19
Deutsch	35
Italiano	51
Français	67
日本語	83





For more product details

please visit: www.coospo.com/faq

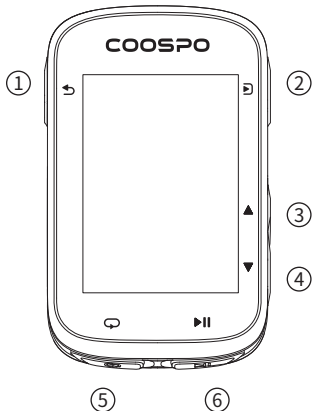
Button Function

EN



Button	Function
① 	Power on/off: Short Press - On Long Press - Off Back: Short Press Map Page: Adjust map zoom level
② 	Menu/Confirm
③ ④ 	Select
⑤ 	Homepage shortcut to history; Lap
⑥ 	Homepage shortcut to ride

Touch Function



Touch Gesture	Function
Tap	Confirm selection. Tap on the ride page to open the quick access page.
Pull Down	Pull down from the top on the home or ride page to view the status page
Swipe Up	Scroll down to view more content. On the ride status page, swipe up to go back to the previous screen.
Swipe Down	Scroll up to view earlier content.
Swipe Left	On the ride page, swipe left to switch between cycling data pages.
Swipe Right	On the ride page, swipe right to switch between cycling data pages. On sub-pages, swipe right to go back.

Initial Settings

ⓘ For the first time use, please charge the device.

When first using the device, please select your language ①. After confirming your language, you will be taken to the device's Homepage ②.

ⓘ To change the language, go to Home > Settings > System > Language.

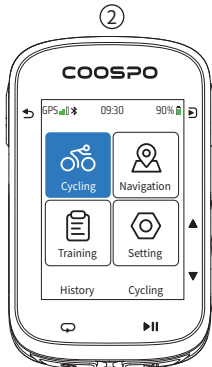

Status Page

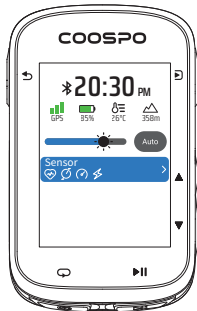

GPS Off	GPS Signal Intensity	Battery	Start
Stop	Auto-Pause	Return to Home	Stop Recording
Function Menu	App Connected Successfully		
<p>Sensor connected: the sensor icon displayed; Sensor added but not connected: sensor icon flashing; Sensor not added: no sensor icon displayed.</p>			
Heart Rate Monitor	Speed Sensor	Cadence Sensor	Power Meter
Bike Trainer	Shifting	Speed&Cadence Sensor	Radar Sensor
	<p>Brightness Bar: Adjust manually via touchscreen backlight level; Auto: Brightness adjusts automatically based on ambient light conditions.</p>		
	<p>Temperature: May differ from actual ambient temperature.</p>		
	<p>Elevation: factory calibrated, default auto-calibration when GPS is turned on.</p>		

Connection & Installation

Connect to CoospoRide

⚠ Please do not pair the bike computer at your phone's Bluetooth settings.

Please download CoospoRide App in Apple Store or Google Play;

Enable the Bluetooth and location permissions on your phone;

Open CoospoRide App > Me > Devices > Add > Bike Computer, choose the model of your bike computer and click on the device ID to connect it.

ⓘ Please ensure that Bluetooth and location permissions are enabled for the App before connecting. Some phone models may not be able to search for Bluetooth devices without authorization.

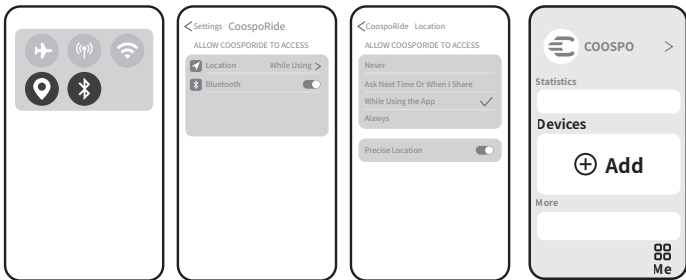

Add Sensor Management

The device can pair with the Bluetooth or ANT+ sensors.

Check sensor compatibility list for more info: www.coospo.com/faq

Add Sensors in Bike Computer

Settings > Sensors > Add Sensor, or Status Page > Sensors > Add Sensor;

Press ▲▼ to select sensor type, press ▶ to start searching;

Press ▲▼ to choose the sensor ID, press ▶ to add a sensor.

❗ After adding speed/power sensors, check the connected sensors and click ▶ to set the wheel circumference/calibrate the power meter.



Add Sensors by App

Open CoospoRide App > Me > Devices >CS600> Sensors >Add, search the sensor you want to add, choose the device ID to add the sensor.

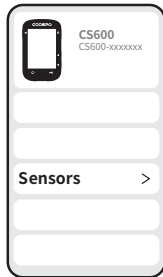

Start a Ride

GPS Positioning

- EN  1. For the initial satellite positioning, please wait 30-90 seconds in an open outdoor area. The date and time of the device will be set automatically after the initial positioning is successful.
2. Please ensure that the bike computer remains stationary while it acquires the GPS signal for the best satellite reception.

Start a Ride

Press ▲▼ on the homepage to select Cycling, press ▶ to enter the cycling page; press ▶|| to start a ride;

Or press ▶|| from any page to enter the cycling page, then press ▶|| to start a ride;

Press ▲▼ at the cycling page to change the data pages you want to display.

Status Page:

After starting the ride, press ↶ to access the status page where you can check the current status and adjust device settings. Press ↶ again to return to the cycling page.

Function Menu:

Pressing ▶ on the cycling page accesses the ride function menu for adjusting and setting various functions within the current ride mode.



Start Riding (Touchscreen)

On the home screen, tap the ride icon to enter the ride data page. Swipe left or right to switch between different ride data screens.

Swipe down from the top to open the status page; swipe up to return to the ride page.

Tap anywhere on the ride page to open the quick ride menu, where you can quickly view GPS, time, battery, sensor status, or perform quick actions.

Tap the   start/pause icon to quickly switch the ride status.

Tap the  (when not riding) to quickly return to the home screen.

Tap the  to enter the ride settings.

Tap the  to quickly end the ride and save the activity.



Navigation

This feature guides you to follow a planned route. When you approach a turn, the device gives a turn prompt so you can keep riding without stopping to check the route.

Ride page > Ride menu > Navigation; or Home > Navigation.

Activity Record:

Select a previous ride's route from your history as the navigation route.

Course

Data Source

Connect the device to your PC using a USB cable. Copy the "gpx" files to the "Courses" folder.

On the bike computer, select the imported route to start navigation.

Navigation Operation

Navigation:

Navigate from the start to the end point of a saved or newly planned route.

Return:

Navigate from the end point back to the start point of a saved or newly planned route.

Zoom Map:

On the navigation page, press the "Back" button to zoom the navigation map.

Training

Ride page > Ride menu > Training; or Home > Training.

Training Courses

Data Source:

1. Create custom training plans in the CoospoRide App, then import them to the bike computer. Note: features depend on the app's latest updates.
2. Select preset courses in the CoospoRide App or synced TrainingPeaks (TP) courses, then import them to the bike computer.
3. Connect the device to your PC via USB cable and copy "fit" training files downloaded from TrainingPeaks or other platforms into the "fit workout" folder.
4. Select the imported training course on the bike computer to start your training.

Target Bar:

▲ shows the upper and lower training target values; the current real-time data position relative to the set target.

Real-Time Data Box:

Displays target type, current real-time value, and whether the current data is above or below the target.

Progress Box:

Shows current step/total steps, current exercise type and duration; displays real-time progress.

Pause Training:

Press the "Ride" button during training to pause.

Stop Training:

In the ride menu, select "Stop Training" to end the current training but continue riding; or select "End Ride" to finish both the training and the ride.

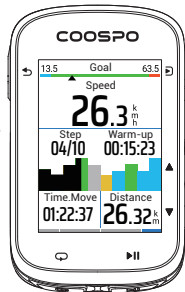

Target Training

You can set ride targets based on data parameters. During training, the device provides real-time feedback on your performance against the target.

Select Distance to set a preset or custom ride distance.

Select Distance & Time to input both a target distance and time.

Select Distance & Speed to input both a target distance and speed.

Once the parameters are set, the training target screen will appear, showing related data. Tap Start to begin the training.

Smart Trainer

To use this feature, a smart trainer must be connected.

Not Connected:

Go to Connect > Add Sensor > Trainer, select the sensor ID, and press the confirm button to add the trainer.

Connected:

Select Free Ride for open training; the device will display real-time gradient and power data.

Or choose Resistance Mode, Slope Mode, or Power Mode and set a target value; the device will automatically adjust the trainer to match the selected mode and target.

Change Trainer Mode:

Ride Page > Ride Menu > Trainer Mode

Adjust Mode Target Value:

Ride Page > Ride Menu > Set Resistance / Slope / Power

Pause Training:

Press the "Ride" button during training to pause.

Stop Training:

In the ride menu, select "Stop Training" to end the current training but continue riding; or select "End Ride" to finish both the training and the ride.

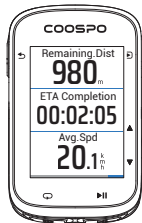

Pages & Fields:

You can customize the page layout, data formatting, and specific data types displayed on your device, or customize all these settings on the CoospoRide App.

Press  to return to the cycling page after customizing to see the updated layout.

Lap:

Pressing  during a ride will start to record a new lap.

 This function allows you to analyze and compare performance of different data segments. You can also set up automatic segmentation rules: e.g. distance, time.

Pause & Save:

When  is on, the ride recording is paused automatically.

You can pause the ride record by pressing  during the ride, and then press  again to continue the ride.

In the Cycling Menu, select Save to end and save the activity.

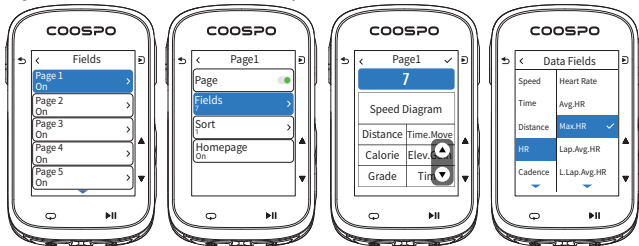

Check Data

History:

Press  on the home page.

Home > Settings > Record > All Activities > Activity Time > History. You can review the saved data here.

Sync data:

After connecting to CoospoRide App, the data will be synchronized ③ to App.

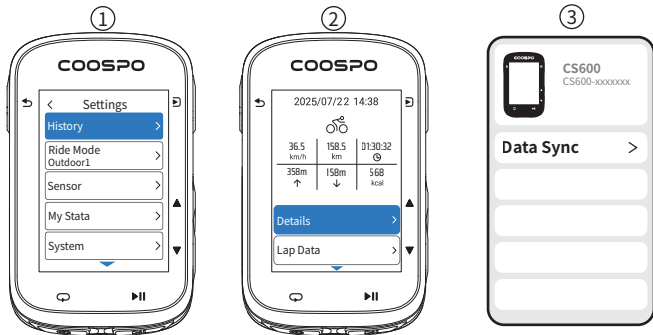

Device Updates

App Updates: Open the CoospoRide App and go to Device > Connected Device > Firmware Update. Click on Check for Updates and follow the guidelines to complete the device update.

Device Settings

Ride Mode

New Mode: Select New Mode and press  to add up to five new ride modes. Each mode can be set separately.

Delete Mode: New mode can be deleted.  The system default mode cannot be deleted.

Alert Settings: Enable alerts and set a data threshold. When the data exceeds the threshold, the bike computer will display a pop-up window to alert you.

Pages & Fields: Consistent with the pages and fields in the Cycling Pages > Functions Menu.

Auto Settings: Auto Lap: Automatically count laps by distance/time/position.

Auto Page Turning: Automatically display all pages by turns.

Auto Start: Automatically start recording riding data without pressing the start button.

Auto Pause: Automatically pause recording when the speed is below the value you set.

GPS: Set GPS Mode

Color: Set your favorite color for each ride mode

My Stats

User Settings: Please make sure the profile is set correctly as it will affect the accuracy of the measurement data.

Heart Rate Zone: If you know your current Max Heart Rate, please input that value. If not, you can use the default maximum heart rate formula (220-age).

Power Zone: If you know your Max Functional Threshold Power, please enter and calculate your FTP automatically. If not, please refer to the system default value: 200.

System Settings

Theme Mode: Set different styles for the main screen.

Backlight: Manual/auto backlight mode.

Power Manage: Battery Saver Mode: Adjust GPS mode and backlight brightness to low power consumption mode.

Auto Sleep: Device will enter sleep mode in 5 minutes without any operation.

Calibration: Altitude Calibration: Manually adjust the altitude data.

Compass Calibration: Calibrate the compass to get accurate navigation directions.

Unit: Customize the unit of data.

Tone: Key tone setting; alert tone setting.

Time: Set the 12-hour or 24-hour clock.

Set the time zone to correct the current time.

Language: Set the Language.

USB: Connect to a PC to transfer data files.

Touchscreen Settings: Turn the touchscreen function on or off.

Data Overwrite: On: Automatically overwrites oldest data when device storage is insufficient.

Off: Unable to save latest records when device storage is insufficient.

 Make sure to regularly sync your history to the CoospoRide App to record all of your ride data.

Factory Reset: Restore All Settings:

Restore settings and ride modes to the factory state, **without deleting the ride data.**

Clear All Data:

Restore settings and ride modes to the factory state, **and delete all data.**

About: Review device information, including device ID, hardware and software versions, and memory status.

USB Sync

- Use the USB cable to connect the bike computer to your PC.
- Export the FIT: Export the FIT file from the "fit activity" folder.
- Import Course: Copy the Courses to the "Courses" folder and will be recognized automatically.

Maps

- The CS600 comes with built-in map files for selected countries or regions. When you ride, the device will automatically load the map based on your current location.
- You can delete unused map files to free up storage space on the device.
- You can also add new map files for other regions to prepare for upcoming rides.
- To download maps, visit "Coospo Official Website > Support > Map Downloads" for available files by country or region.
- Note: Before deleting any map files, please double-check the country or region. If you're unsure, contact customer service first.

Contact us



Website: www.coospo.com



E-mail: support@coospo.com

Attentions

The information contained in this manual is for reference only. The product described above may be subject to alteration owing to the manufacturer's continuing research and development plans without prior notice.

Disclaimer

The information contained in this manual just for reference. The product described above may be subject to alteration owing to the manufacturer's continuing research and development plans, without making an announcement in advance.

We shall not bare any legal responsibility for any direct or indirect, accidental or special damages, losses and expenses arising from or in connection with this manual or the contained product.

FCC statement

NOTE: This equipment has been tested and found to comply with the limits for a Class B digital device, pursuant to part 15 of the FCC Rules. These limits are designed to provide reasonable protection against harmful interference in a residential installation. This equipment generates, uses and can radiate radio frequency energy and, if not installed and used in accordance with the instructions, may cause harmful interference to radio communications. However, there is no guarantee that interference will not occur in a particular installation. If this equipment does cause harmful interference to radio or television reception, which can be determined by turning the equipment off and on, the user is encouraged to try to correct the interference by one or more of the following measures:

- Reorient or relocate the receiving antenna.
- Increase the separation between the equipment and receiver.
- Connect the equipment into an outlet on a circuit different from that to which the receiver is connected.
- Consult the dealer or an experienced radio/TV technician for help

Changes or modifications not expressly approved by the party responsible for compliance could void the user's authority to operate the equipment.

This device complies with Part 15 of the FCC Rules. Operation is subject to the following two conditions:

(1) this device may not cause harmful interference, and (2) this device must accept any interference received, including interference that may cause undesired operation.

IC WARNING

This device contains licence-exempt transmitter(s)/receiver(s) that comply with Innovation, Science and Economic Development Canada's licence-exempt RSS(s). Operation is subject to the following two conditions:

- (1) This device may not cause interference.
- (2) This device must accept any interference, including interference that may cause undesired operation of the device.

L'émetteur/récepteur exempt de licence contenu dans le présent appareil est conforme aux CNR d'Innovation, Sciences et Développement économique Canada applicables aux appareils radio exempts de licence. L'exploitation est autorisée aux deux conditions suivantes :

- (1) L'appareil ne doit pas produire de brouillage;
- (2) L'appareil doit accepter tout brouillage radioélectrique subi, même si le brouillage est susceptible d'en compromettre le fonctionnement.



Waste electrical products should not be disposed of with household waste. Please recycle where facilities exist. Contact your local government or a retailer for additional information.



- Do not open or modify the product.
- Do not disassemble or attempt to service this product.



- This product is safe under normal and reasonably foreseeable operating conditions.
- If product is operating improperly, call COOSPO support.
- Product must be returned to the manufacturer for any service or repair.



Manufacturer: Shenzhen Coospo Tech Co., Ltd

Address: 6F, Building A, Dingxin Science Park, Xinan Street, Baoan District, Shenzhen

Contact: +86 (755) 23594795 support@coospo.com

Website: www.coospo.com