

1 Head cup of balane bike removal instruction

Specification

Suitable 7/8" press fit external cup.

Visit operation detail at Super B
website:<http://www.superbiketool.com/>,
Click Product ➡ Product ➡
Frame & Fork ➡ 5. ➡ TB-1929A

Steps

- 1-1. Pull the head cup remover through the frame until flared ends snap in behind cup. (see picture 1)
- 1-2. Make the end of head cup remover withstand the edge inside of head cup. (see picture 2)
- 1-3. Use a hammer to hit the top of the remover to remove the cup. Then pull out head cup remover from the frame. (see picture 3)
- 1-4. Reverse the frame and repeat the steps from 1-1 to 1-3 to remove the upper cup.



(Picture 1)

⚠ Use the hammer to hit the end of remover to assist it in place

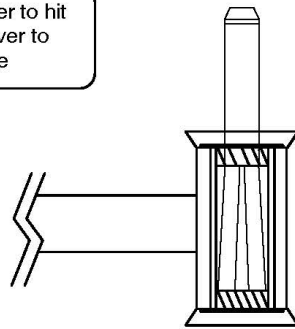

(Picture 2)



(Picture 3)

2 Press fit bottom bracket bearings removal instruction

Specification

Fits most internal diameter 24~30 mm bottom bracket bearings.

Steps

- 2-1. Pull the B.B. remover through the bottom bracket until flared ends snap in behind cup. (see picture 4)
- 2-2. Make the flared ends withstand the edge inner side of the bottom bracket bearing cup. (see picture 5)
- 2-3. Use a hammer to hit the top of the remover to remove the bearing. (see picture 6)
- 2-4. Take off the removed B.B. bearing and repeat steps from 2-1 to 2-3 to remove the other B.B. bearing.



(Picture 4)

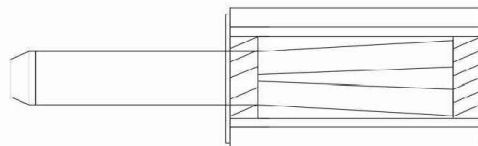

(Picture 5)

⚠ Use the hammer to hit the end of remover to assist it in place



(Picture 6)

1 平衡滑步車頭碗組珠碗拆卸使用說明

適用尺寸

適用7/8英寸外露式頭碗組珠碗。

步驟

- 1-1. 將頭碗組珠碗拆卸器由下往上穿入頭管中。(如圖一所示)
- 1-2. 直到頭碗組珠碗拆卸器尾部(開叉端)完全進入頭管中，並抵住前叉管下方的頭碗組珠碗的碗槽基座內側。(如圖二所示)
- 1-3. 使用錘子敲擊頭碗組珠碗拆卸器前端，直到頭碗組珠碗離開頭管。(如圖三所示)
- 1-4. 拆卸另一端頭碗組珠碗時，請重覆以上拆卸步驟即可。

詳細操作影片請至Super B
官網<http://www.superbiketool.com/>
觀看，點擊 ➔ Product ➔ Frame
& Fork ➔ 5. ➔ TB-1929A



(圖一)

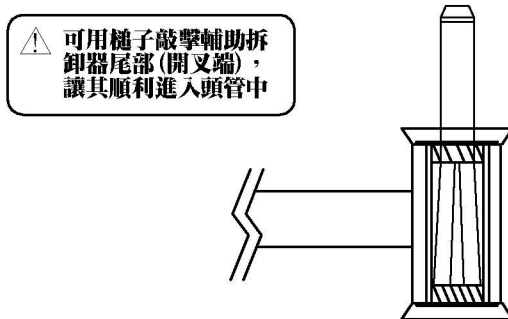

(圖二)



(圖三)

⚠ 可用錘子敲擊輔助拆卸器尾部(開叉端)，讓其順利進入頭管中

2 壓入式五通培林拆卸使用說明

適用尺寸

適用大部分內徑24~30mm的五通培林。

步驟

- 2-1. 將五通培林拆卸器穿入五通中。(如圖四所示)
- 2-2. 直到五通培林拆卸器尾部(開叉端)完全進入五通中，並抵住培林內側。(如圖五所示)
- 2-3. 使用錘子敲擊五通培林拆卸器前端，直到培林離開五通。(如圖六所示)
- 2-4. 拆卸另一端五通培林時，請重覆以上拆卸步驟即可。



(圖四)

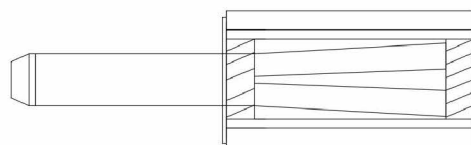

(圖五)



(圖六)

⚠ 可用錘子敲擊輔助拆卸器尾部(開叉端)，讓其順利進入頭管中